

FLAT TYPE B | 2B 1T

Available in Tower A

SOLD OUT

Wall hanging
Wardrobe Space
in each room
for maximum
utilization of
space

Multipurpose
Double Height
Open Terrace for
your comfort

Cross
ventilated
Bedroom
for fresh air
and light

Glass window
beside the
Open Terrace
for more light
in the Living
Dining room

Modular
Toilet, Bath and
Wash Basin area
can be used
by 3 persons at
one time

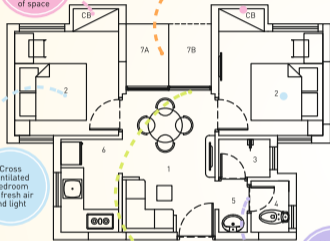

Carpet area 369 sq.ft.

Built up area 446 5q. ft.

Standard built up area 620 sq.ft.

1	Living/Dining	8'0" x 12'0"
2	Bedroom	11'0" x 9'0" (9'0" x 9'0" without CB)
3	Bathroom	4'5" x 3'3"
4	WC	3'3" x 4'5"
5	Basin	4'5" x 2'6"
6	Kitchen	5'0" x 8'0"
7A	Open terrace	3'8" x 5'5"
7B	Open terrace	3'8" x 5'5"