

# Unit Plan

FLAT B1 | 2B 1T  
Tower B

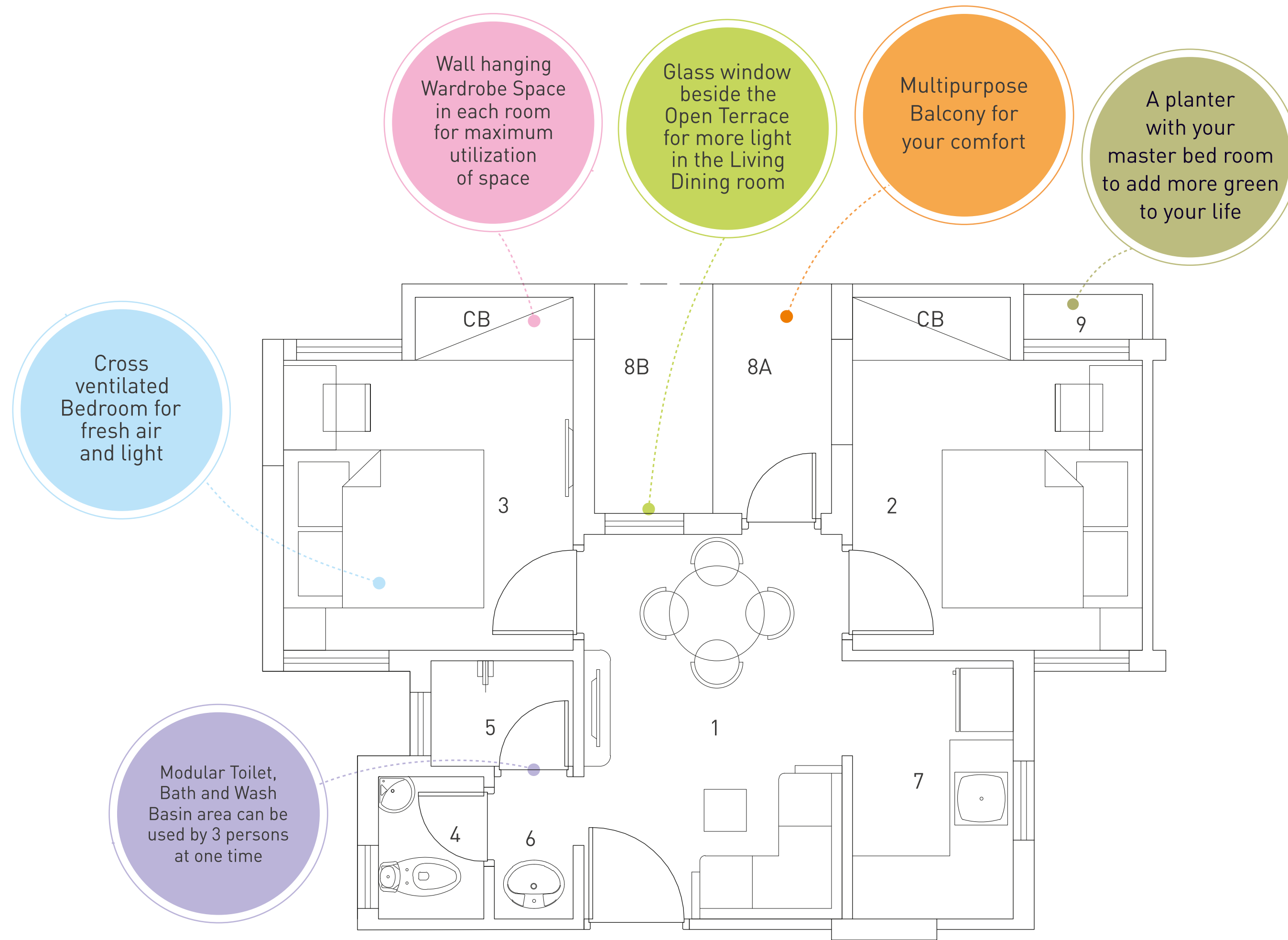

Carpet area	Carpet + Balcony area	Built up area	Standard built up area
373	399	465	640

① Living/Dining	8'0" x 12'0"
② Bedroom	9'0" x 11'0" (9'0" x 9'0" without CB)
③ Bedroom	9'0" x 11'0" (9'0" x 9'0" without CB)
④ WC	3'3" x 4'5"
⑤ Bathroom	4'5" x 3'3"

⑥ Basin	2'6" x 4'5"
⑦ Kitchen	5'0" x 8'0"
⑧A Balcony	3'8" x 7'2"
⑧B Balcony	3'8" x 7'2"
⑨ Planter	3'10" x 1'9"

# Unit Plan

FLAT B1 | 2B 1T

Tower B



Carpet area	Carpet + Balcony area	Built up area	Standard built up area
373	399	465	640

① Living/Dining	8'0" x 12'0"
② Bedroom	9'0" x 11'0" (9'0" x 9'0" without CB)
③ Bedroom	9'0" x 11'0" (9'0" x 9'0" without CB)
④ WC	3'3" x 4'5"
⑤ Bathroom	4'5" x 3'3"

⑥ Basin	2'6" x 4'5"
⑦ Kitchen	5'0" x 8'0"
⑧A Balcony	3'8" x 7'2"
⑧B Balcony	3'8" x 7'2"
⑨ Planter	3'10" x 1'9"