

FLAT B | 2 B 1 T

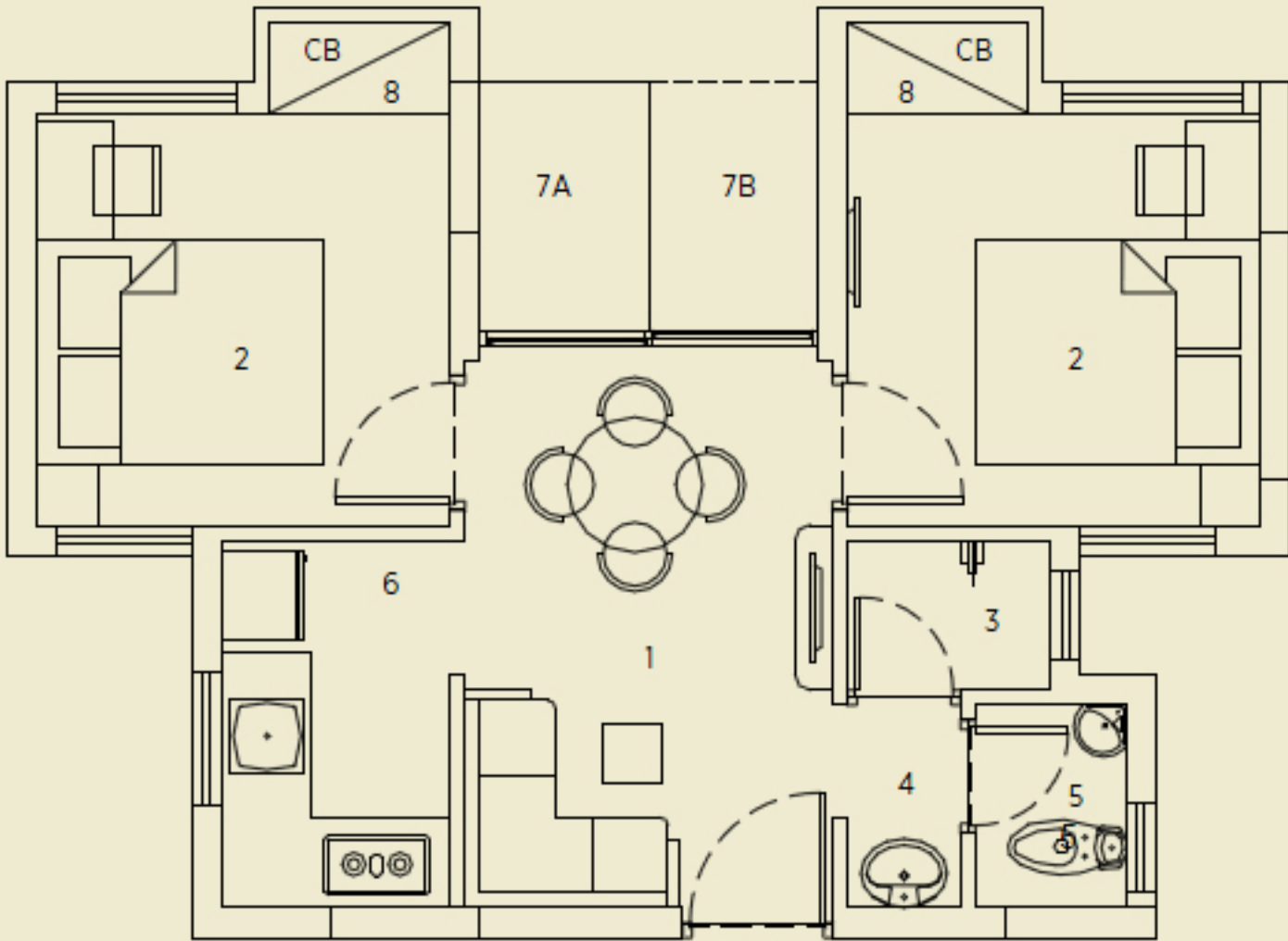

Flat Type B | 2 B 1 T  
Carpet area 369 sq ft  
Built up area 446 sq ft  
Standard built up area 620 sq ft

1	Living/Dining	8'0"x12'0"
2	Bedroom	9'0"x9'0"
3	Bathroom	4'5"x3'3"
4	WC	3'3"x4'5"
5	Basin	4'5"x2'6"
6	Kitchen	5'0"x8'0"
7A*	Open terrace	3'8"x5'5"
7B*	Open terrace	3'8"x5'5"
8	Cabinet area	3'11"x2'0"

\*Please refer to the Tower Plan